



Pneumatic Timer - PT Series

PT Pneumatic Timer

Technical information

Pressure range:	20 to 140 PSI
Control port pressure:	20 to 140 PSI
Valve flow rate:	100 PSI - 9 CFM
Temperature range:	-30°C...+70°C (Subject to moisture removal) -20°F...+165°F
Mounting:	Upright vertical mount (Y1 option available, see below)
Time setting:	Via front dial knob, infinite throughout respective time range
Repeatability:	Up to 200 sec. +/- 5%, over 200 sec. +/- 10%
Setting accuracy:	+/- 10% of full scale value
Reset:	Removal of control pressure
Reset time:	60ms (PT31 version only)
Operating medium:	5 micron filtered air or non-aggressive gas, non-lubricated



Other information

Other options are available for this product, use suffix code **Y1** for horizontal mountable calibrated versions, **SS** for a stainless steel control port fitting or **DS** for a dial stop between two timing points (please specify settings), example PT41D-Y1-SS-DS

	Ports	Order code
Timing starts on application of air to control port C	1/8 NPTF	PT31*
Timing starts by removal of air to control port C	1/8 NPTF	PT41*

Dimensional drawings

Valve connection options:

- 3 AS INPUT - Closed/Open
- 2 AS INPUT - Diverter
- 1 AS INPUT - Closed/Open

Applying pressure to the control port for a minimum of 100ms shifts the valve (60ms switch time), PT41 versions only.

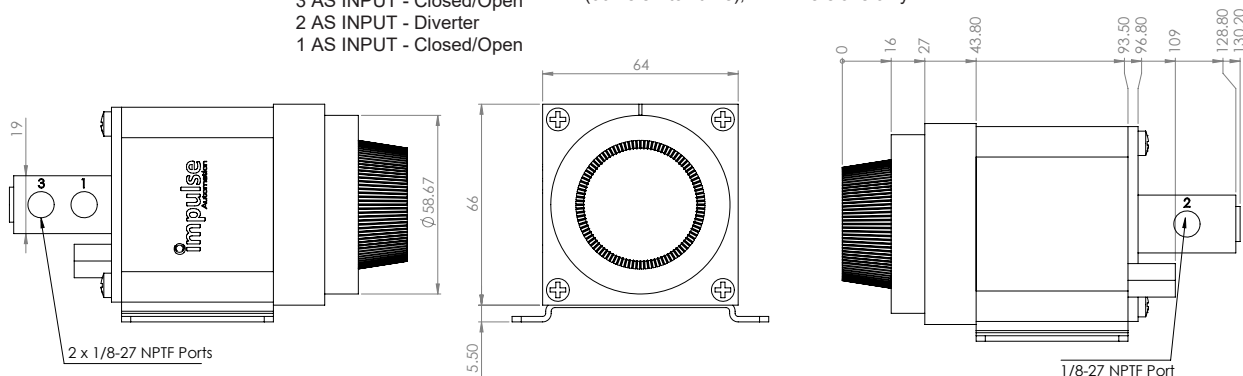

Available Time Ranges	
A	0.1 - 1 Second
B	0.5 - 5 Seconds
C	1.5 - 15 Seconds
D	5 - 50 Seconds
E	20 - 200 Seconds
K	1 - 300 Seconds
F	1 - 10 Minutes
H	3 - 30 Minutes
I	6 - 60 Minutes
Specify time range in part number eg for 0.1 - 1 seconds specify PT31A PT41A	

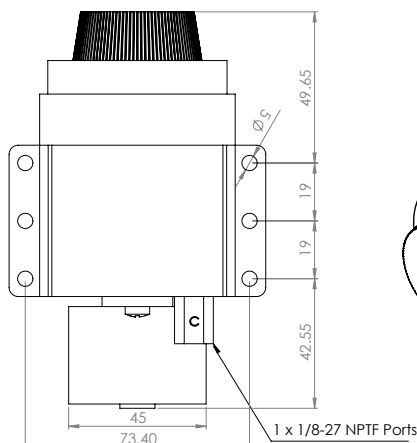

Impulse Automation Limited
United Kingdom
Company Registration 665193

Information shown in these data sheets are for guidance purposes only, no liability is accepted for any errors or omissions. The designer or user is solely responsible for the safe and proper use of these parts, assemblies or equipment described.