

Logic Valves & Flow Control

Pneumatic Non-Return Valve



Technical information

Pressure range: 2 - 8 bar
Temperature range: -18°C...+70°C
Materials: Nickel plated brass
Operating medium: 5 micron filtered, lubricated or non-lubricated compressed air.

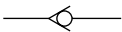
Symbol	Description	Ports	Order code
	Non-return valve (one way flow)	M5	VU05
	Non-return valve (one way flow)	G1/8	VU08
	Non-return valve (one way flow)	G1/4	VU04
	Non-return valve (one way flow)	G3/8	VU03
	Non-return valve (one way flow)	G1/2	VU02

Dimensional drawings

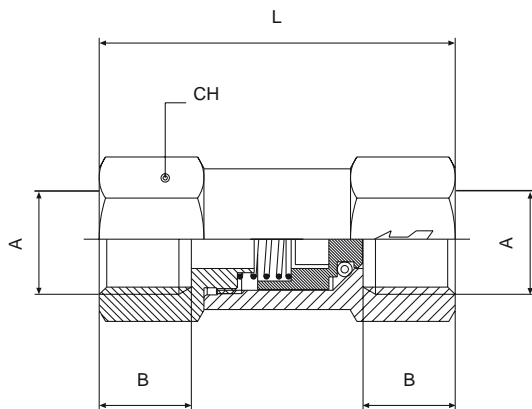

A	B	L	CH
M5	5.5	26.5	8
1/8	8.5	35.5	13
1/4	11	43	17
3/8	12	58	24
1/2	15	63	24

Impulse Automation Limited
 United Kingdom
 Company Registration 665193