

# Logic Valves & Flow Control

## Pneumatic One-Way Flow Restrictor - Banjo Type

### Technical information

**Pressure range:** Max. 8 bar  
**Temperature range:** -10°C...+70°C  
**Materials:** Brass body & ferrule (Aluminium sleeve with brass collets\*\*)  
**Flow rate:** See table below.  
**Nominal orifice:** 2mm  
**Operating medium:** 5 micron filtered, lubricated or non-lubricated compressed air.

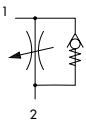
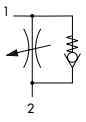

Symbol	Description	C	D	E	F	G	H	J	Threads	Order code
	Exhaust type with 4mm push-in tube connections	17	4	18	21	8.5	8	-	M5	<b>47.075**</b>
	Exhaust type with 6mm push-in tube connections	24.5	17	27	32	14	10	-	G1/8	<b>47.090**</b>
	Exhaust type for 5 x 1 tube push-on connections	14.5	4	18	21	-	-	8	M5	<b>47.070</b>
	Exhaust type for 6 x 1 tube push-on connections	14.5	4	18	21	-	-	9	M5	<b>47.080</b>
	Exhaust type for 6 x 1 tube push-on connections	21	7	27	32	-	-	9	G1/8	<b>47.085</b>
	Inlet type with 4mm push-in tube connections	17	4	18	21	8.5	8	-	M5	<b>47.076**</b>
	Inlet type for 5 x 1 tube push-on connections	14.5	4	18	21	-	-	8	M5	<b>47.071</b>
	Inlet type for 6 x 1 tube push-on connections	14.5	4	18	21	-	-	9	M5	<b>47.081</b>

### Dimensional drawings

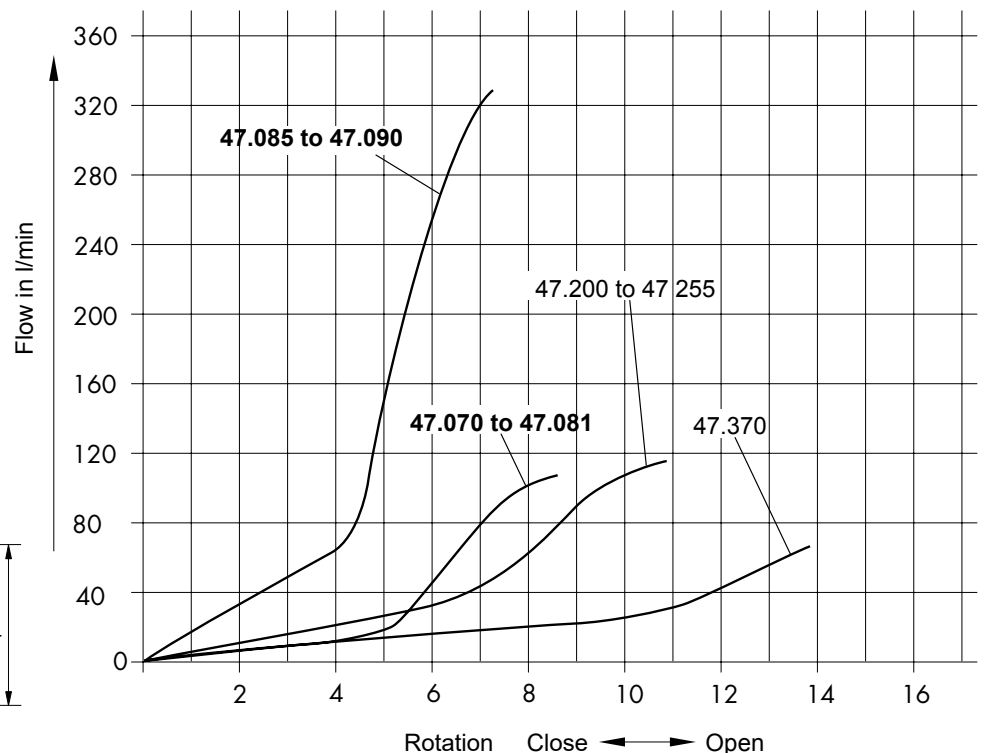
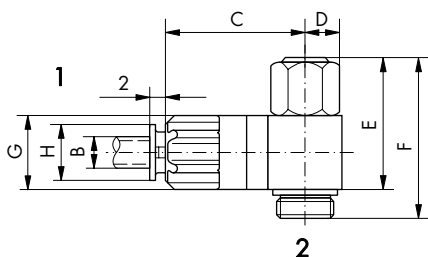
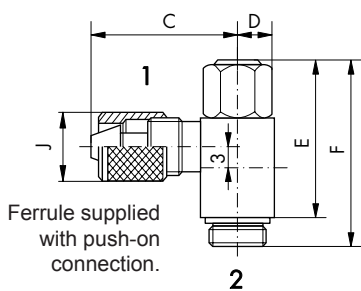

**Impulse Automation Limited**  
 United Kingdom  
 Company Registration 665193