

H24 Series Linear Solenoid Push and/or Pull Type

H	24	06	- F -	24 V DC	100 % ED	Order specifications
H						Linear solenoid
	24					Sizes
						Design type
		06				Pull type solenoid
		46				Thrust type solenoid
		86-R				Combi type solenoid with return spring ²⁾
			F			Coil terminals
				24		Flying leads (10 cm standard length)
						Nominal voltage (standard voltage) ³⁾
					100 % ED	Perm. duty cycle under air cooled conditions (LK)

²⁾ Series H 2486-R... solenoids are available with return spring F (0 mm) = 1.5 N and F (8 mm) = 0.3 N

³⁾ Other DC voltages are available on request.

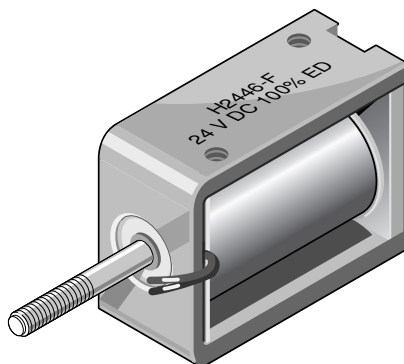

Weight:

Complete

solenoid: appr. 85 g

Armature: appr. 25 g

Standard:

Voltage: 24 V DC

Flying leads: 10 cm

Insulation class: B (max. permissible temperature = 130 °C)

	100	45	28	15	5	% Perm. duty cycle (ED) ⁴⁾
	6	13,8	21	40	102	W Nominal coil power P_N
	23				9	ms Actuation time (ED)

⁴⁾ If solenoid is mounted directly onto a flat metal surface of at least 60 cm², the duty cycle can be extended up to 1.3 x nominal rating

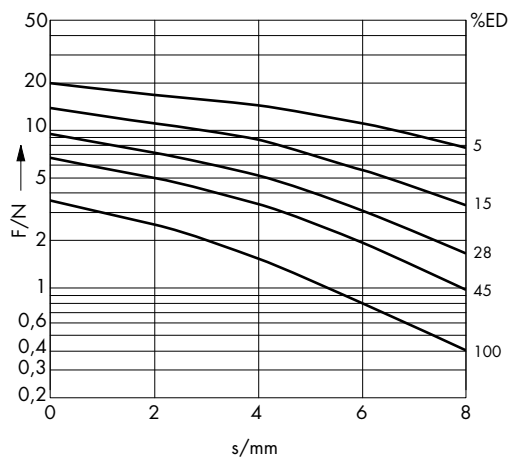

Force vs. Stroke diagram $F = f(s)$

Force measured when operating in horizontal position, at 90 % rated voltage and with winding at operating temperature

stroke $s = 0$ corresponds to armature in fully home position

Force vs. stroke characteristics measured without return spring

Impulse Automation Limited
United Kingdom
Company Registration 665193

Information shown in these data sheets are for guidance purposes only, no liability is accepted for any errors or omissions. The designer or user is solely responsible for the safe and proper use of these parts, assemblies or equipment described.

H24 Series Linear Solenoid Push and/or Pull Type

H2406 pull type solenoid

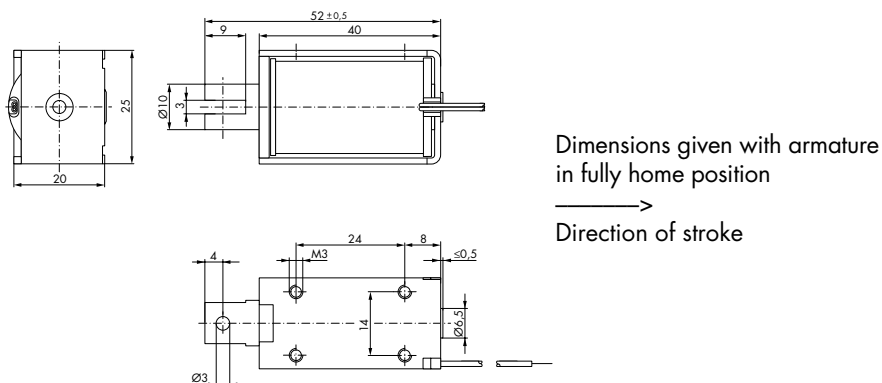

H2446 thrust type solenoid

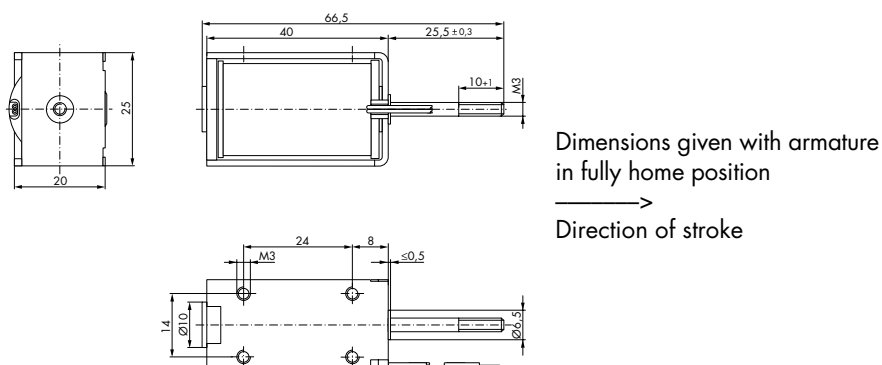

H2486-R combi type solenoid with return spring

