

ISO 1 Solenoid Operated Pneumatic Valves

5/3 Way Double Solenoid Control Valve

Technical information

Pressure range: 2.5-10 bar
Temperature range: -15°C...+50°C
Housing: Die-cast and lacquered aluminium alloy
Seals: NBR
Lubricant: Not required.
Earthing contact: Part of the standard device.
Operating medium: 5 micron filtered, lubricated or non-lubricated compressed air.



Other information

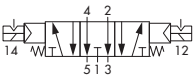
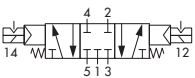

For ATEX certification use suffix code "EX" for example 76.XXX.XX.XX.EX
 Subplates are available for this product, see data sheets M1004 & M1005.
 Order coils & connecting plugs separately, see data sheet M1002.

Symbol	Description	Type	Orifice	Order code
	5/3 way spring return to centre, ports 2 & 4 exhaust	Spool	6mm	76.084.02.00
	5/3 way spring return to centre all ports closed	Spool	6mm	76.084.12.00

Dimensional drawings

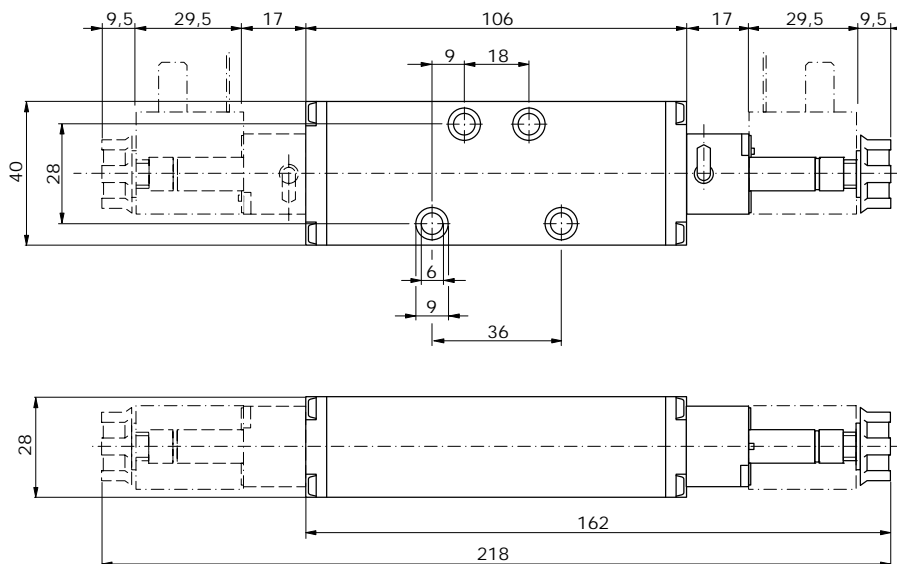

Flow rate orifice spool type

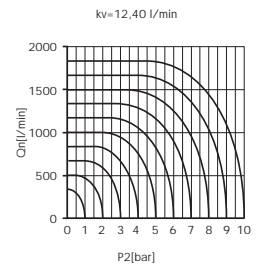

Impulse Automation Limited
 United Kingdom
 Company Registration 665193