

# CETOP Pneumatic Cylinder ISO 6432

## Type ISO 6432 With Cushioning Ø 16mm - 25mm

### Technical information

**Operating pressure:** Double acting Ø16mm 1.0-10 bar/Ø20-25mm 0.5-10 bar  
**Temperature range:** -20°C...+70°C  
**Housing/end caps:** Cr-Ni steel/Aluminium  
**Rod:** Cr-Ni steel  
**Seals:** Perbunan  
**Lubricant:** Shell Tellus C10  
**Operating medium:** 5 micron filtered, lubricated or non-lubricated compressed air.



### Other information:

**Ex** For ATEX certification use code "X" for example 26.X.241.XXX  
 Sensors are available for this product, see data sheets TX1002/TX1003.  
 Mountings are available for this product, see data sheets MS1005.

Ø	A	B	C	D	E	F	G	H	J	K	L	M	N	O <sub>(H9)</sub>	P	R <sub>(d13)</sub>	T	U	V	X	SW1	Double acting Max stroke available
16	17	M16x1.5	22	M6	16	21	M5	82	3.5	19.5	95	5	9	6	6.5	12	24	22	8	3	5	350 mm
20	20	M22x1.5	24	M8	20	27	G1/8	95	4	22.5	110	5	12	8	8	16	32	27	10	4	7	500 mm
25	22	M22x1.5	28	M10x1.25	22	27	G1/8	104	4	26	119	5	12	8	9	16	32	27	10	4	9	500 mm

### Dimensional drawings & ordering information

Minimum/maximum strokes apply, see table.

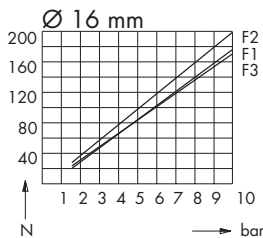

F1 = single acting cylinders  
 F2 = double acting cylinders in forward stroke  
 F3 = double acting cylinders in return stroke

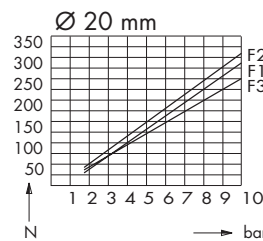

**Length of cushioning:**  
 Ø 16 13.5mm  
 Ø 20-25 16.0mm

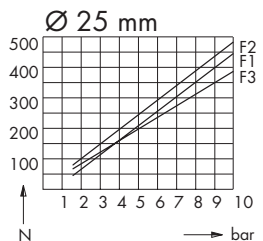

#### Double Acting With Magnetic Piston

Area ratio (due to the reduction of the piston rod section).  
 Ø16-25 7:6

**To order:** 26.241.XXX 16mm bore + stroke  
 27.241.XXX 20mm bore + stroke  
 28.241.XXX 25mm bore + stroke

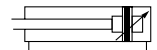

Non-magnetic versions are also available, for example 2X.24.XXX

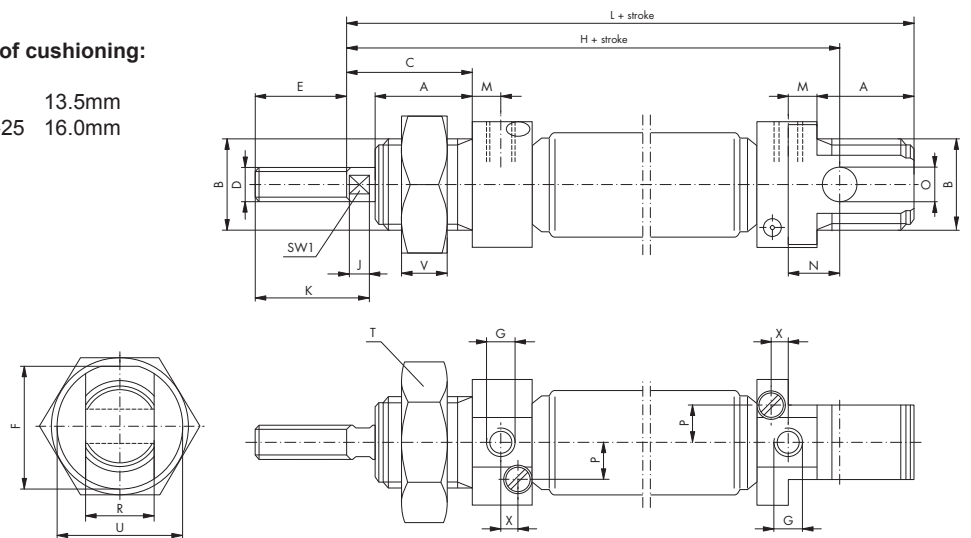

**Impulse Automation Limited**  
**United Kingdom**  
**Company Registration 665193**