

Manually Operated Pneumatic Valves

Pneumatic Knob Operated Valve G1/8 Ports - 5/2 Way

Technical information

Pressure range: 0-10 bar
Temperature range: -15°C...+50°C
Housing: Die-cast and lacquered zinc alloy
Seals: NBR
Lubricant: Not required
Operating medium: 5 micron filtered, lubricated or non lubricated compressed air.



Other information

 For ATEX certification use suffix code "EX" for example 76.XXX.XX.XX.EX
 For NPT ports use prefix code "75" for example 75.XXX.XX.XX

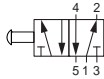
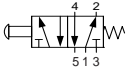
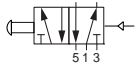
Symbol	Description	Type	Orifice	Ports	Button	Order code
	5/2 way push-pull maintained position	Spool	6mm	G1/8	Black	76.023.27.40
	5/2 way spring return	Spool	6mm	G1/8	Black	76.023.27.41
	5/2 way push-pull maintained position with pilot return **	Spool	6mm	G1/8	Black	76.023.27.42

Dimensional drawings

**Dimensional drawing upon request

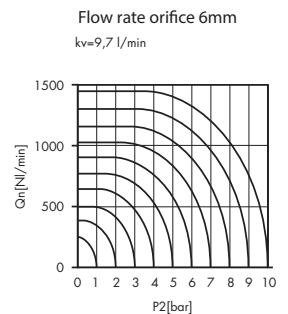
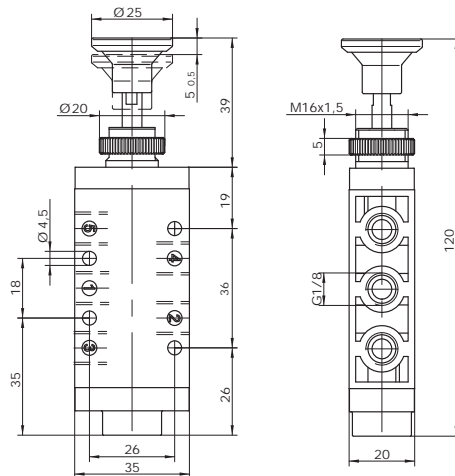

Impulse Automation Limited
United Kingdom
Company Registration 665193