

URM50 Series Bi-directional Linear Solenoid

URM	50	- N -	24 V DC	100 % ED	Order specifications
URM					Linear solenoid
	50				Design type
					Coil terminals
		F			Flying leads (10 cm standard length)
		N			Plug-in socket connection ¹⁾
			24		Nominal voltage (standard voltage) ²⁾
				100 % ED	Perm. duty cycle under air cooled conditions (LK)

¹⁾ For socket 6.3 DIN 46247

²⁾ Other voltages are available on request up to 230 V DC

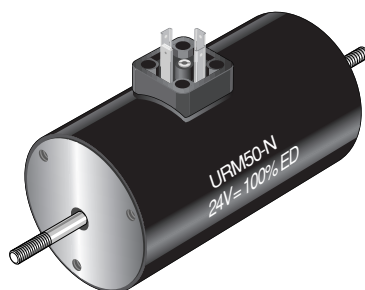

Weight:

Complete

solenoid: appr. 1200 g

Armature: appr. 180 g

Standard:

Voltage: 24 V DC

Flying leads: 10 cm

Insulation class: B (max. permissible temperature = 130 °C)

Long life expectancy through plastic bobbin armature bearing.

Plug Z803 available as accessory.

	100	70	40	25	15	5	% Perm. duty cycle (ED) ³⁾
	15	24	38	56	89	280	W Nominal coil power P _n

³⁾ If solenoid is mounted directly onto a flat metal surface, an increase in relative duty cycle is permissible (please ask for advice)

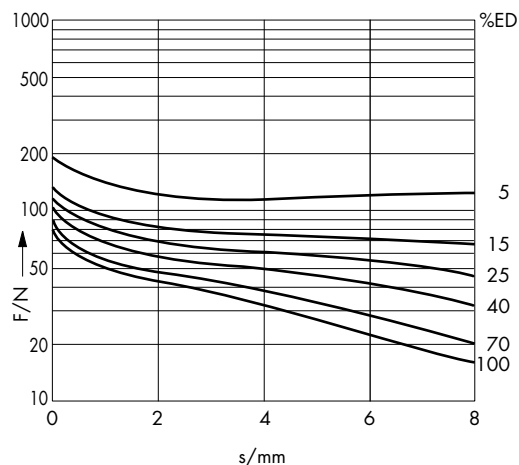

Force vs. Stroke diagram $F = f(s)$

Force measured when operating in horizontal position, at 90 % rated voltage and with winding at operating temperature

stroke $s = 0$ corresponds to armature in fully home position

Impulse Automation Limited
United Kingdom
Company Registration 665193

Information shown in these data sheets are for guidance purposes only, no liability is accepted for any errors or omissions. The designer or user is solely responsible for the safe and proper use of these parts, assemblies or equipment described.

URM50 Series Bi-directional Linear Solenoid

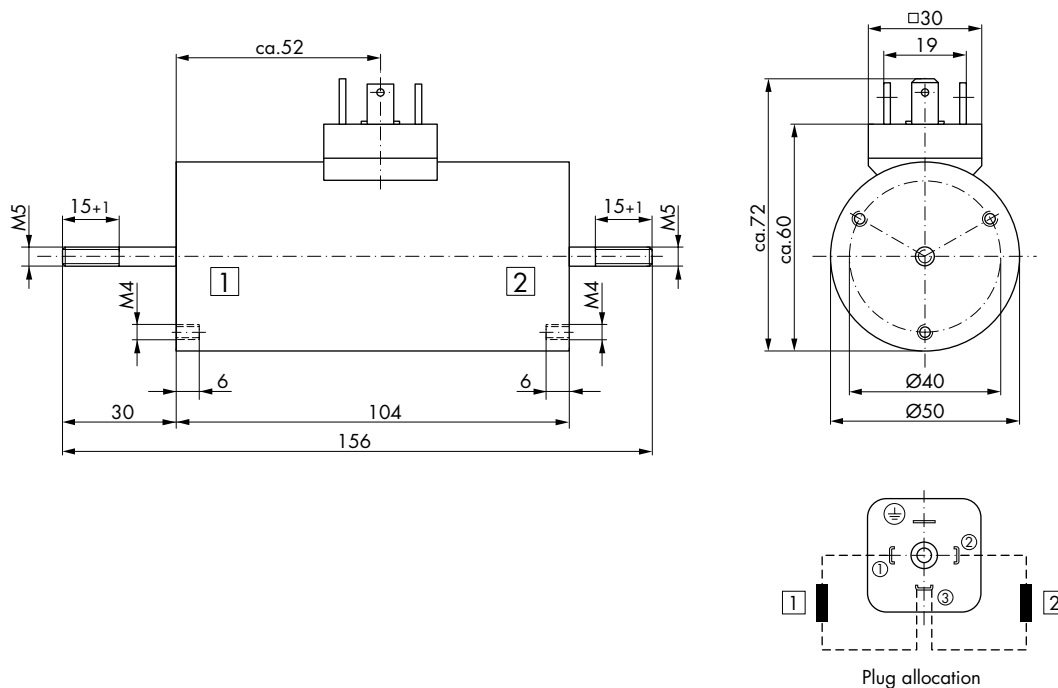

Dimensions given when
system 1 current-carrying
↔
Direction of stroke

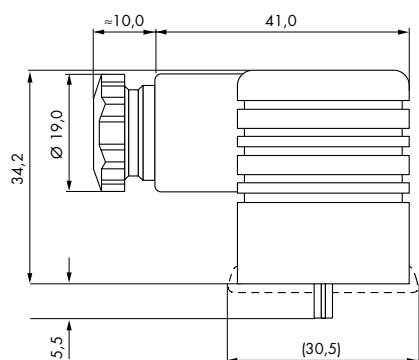

Plug-in socket Z803
Screw joint PG 9
for lead diameter 4.5 - 7 mm



Impulse Automation Limited
United Kingdom
Company Registration 665193

Information shown in these data sheets are for guidance purposes only, no liability is accepted for any errors or omissions.
The designer or user is solely responsible for the safe and proper use of these parts, assemblies or equipment described.