

PulseTech Micro Pneumatic Valves

Lever Valves

Technical information

Pressure range:	0-10 bar
Temperature range:	Max. +60°C
Orifice/Flow rate:	2.5mm / 100 NI/min
Housing:	Nickel plated brass
Seals:	NBR
Lubricant:	Not required
Operating medium:	5 micron filtered, lubricated or non-lubricated compressed air

Other information

Minimum order quantities may apply. Preferred types **
See drawings for port orientation.

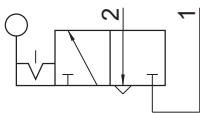
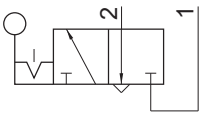
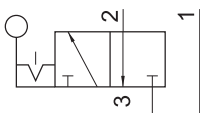

Symbol	Description	Ports	Side Ported
	3/2 way [bistable lever, exhaust through body, short body]	M5 threaded	PT.25.60.1.S5**
	3/2 way [bistable lever, exhaust through body, long body]	M5 threaded	PT.25.61.1.S5 **
	3/2 way [bistable lever, threaded exhaust port, short body]	M5 threaded	PT.25.62.1.S5

Dimensional drawings

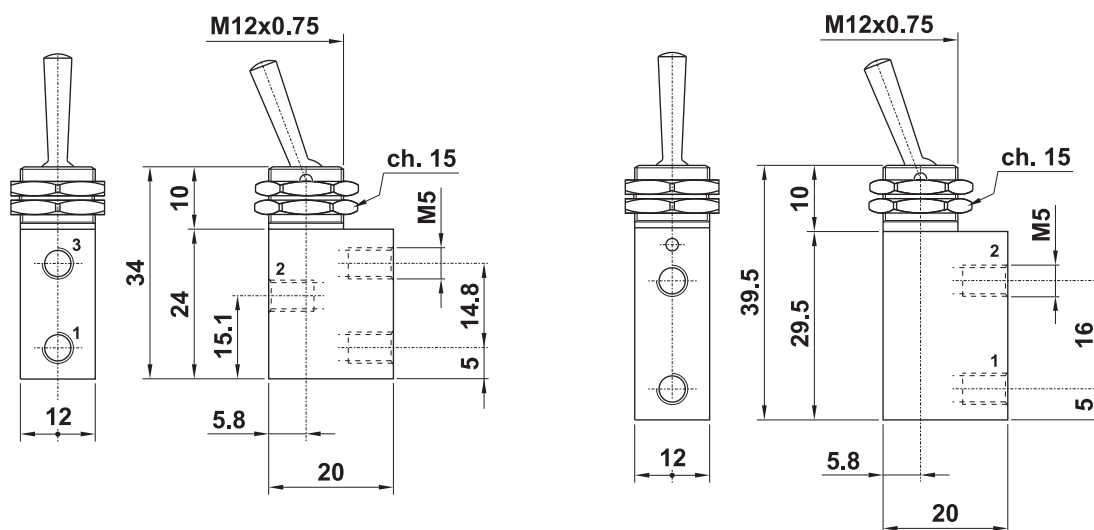

Impulse Automation Limited
United Kingdom
Company Registration 665193