

Cleanline Cylinder Mountings

Male Trunnion

Code	∅	CS	L	XD+	CD	MR
18.002.01	32	26	22	142	10	11
18.002.02	40	28	25	160	12	13
18.002.03	50	32	27	170	12	13
18.002.04	63	40	32	190	16	17
18.002.05	80	50	36	210	16	17
18.002.06	100	60	41	230	20	21

Includes fixing bolts.

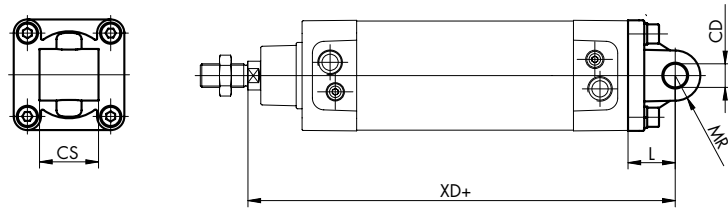

Mounting Bracket

Code	∅	AT	AH	TR	AB	SA+	XA+	AO
18.005.01	32	4	32	32	7	142	144	35
18.005.02	40	4	36	36	9	161	163	43
18.005.03	50	4	45	45	9	170	175	47
18.005.04	63	6	50	50	9	185	190	47
18.005.05	80	6	63	63	12	210	215	61
18.005.06	100	6	71	75	14	220	230	66

Includes fixing bolts
(One bracket supplied).

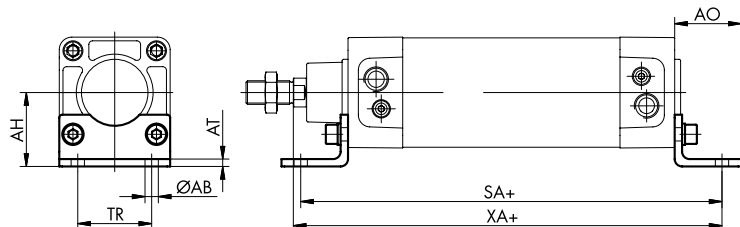

Mounting Plate

Code	∅	W	ZF+	R	FP	TF	UF	ZB+	AR	MF
18.006.01	32	16	130	32	7	64	80	120	50	10
18.006.02	40	20	145	36	9	72	90	135	55	10
18.006.03	50	25	155	45	9	90	110	143	65	12
18.006.04	63	25	170	50	9	100	120	158	75	12
18.006.05	80	31	189	63	12	126	150	174	95	15
18.006.06	100	36	204	75	14	150	178	189	115	15

Includes fixing bolts
(One plate supplied).

Rear mounting only
for Multi-Tandem
cylinders.

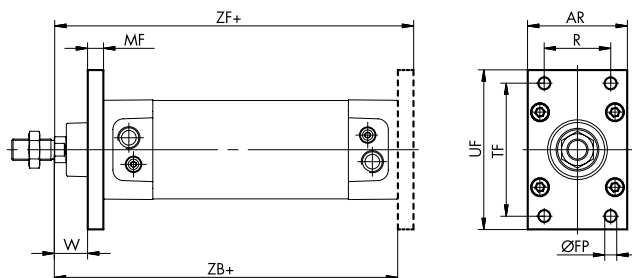

Impulse Automation Limited
United Kingdom
Company Registration 665193