

# Logic Valves & Flow Control

## Non-Return Valve / Stainless Steel

### Technical information

**Pressure range:** 0.3\*-25 bar (\*Approximate opening pressure)  
**Temperature range:** -10°C...+120°C  
**Housing material:** Stainless steel 316L (1.4404)  
**Seals:** FKM  
**Operating medium:** 5 micron filtered, lubricated or non-lubricated compressed air.  
**Other information:** Minimum order quantities may apply, please ask for further information.

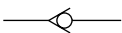

Symbol	Description	A	B	L	CH	Order code
	Non-return valve G1/8	G1/8	9	38	16	<b>66062-18-00</b>
	Non-return valve G1/4	G1/4	10.5	38	16	<b>66062-14-00</b>
	Non-return valve G3/8	G3/8	13	44	19	<b>66062-38-00</b>
	Non-return valve G1/2	G1/2	15	50	24	<b>66062-12-00</b>

### Dimensional drawings

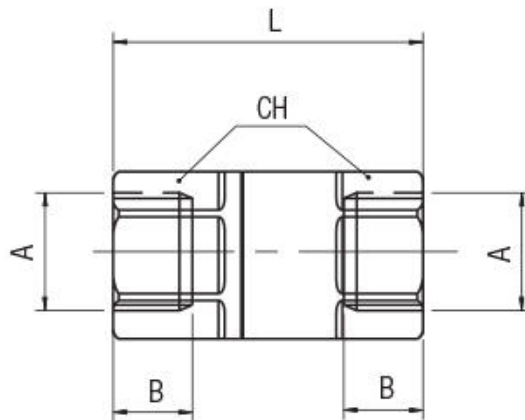

**Impulse Automation Limited**  
**United Kingdom**  
**Company Registration 665193**